

DH-HAC-PT1200B-IL-A-E2Z

2MP Smart Dual Light HDCVI Vari-focal PT Camera



Series Overview

The PT Series boasts a compact design that enables horizontal and vertical rotation, delivering a wide monitoring area. With the integration of both panoramic and detail cameras, it achieves an exceptional balance between the two. Moreover, this series features diverse models with distinct structures, ensuring it can cater to the requirements of various large-scale monitoring scenes.

Functions

Pan & Tilt

Developed with a PT design, it has a dual shaft and dual motor. The motor can control the pan range from 0° to 355° and the tilt range from 0° to 90°, covering all the corners without any dead angles. This extends the monitoring area.

Vari-Focal Dual-Lens

By seamlessly integrating dual sensor fusion technology and harnessing the power of two fixed-focal lenses that work together, the camera excels at performing zoom functions. This enables it to effortlessly record scenes that demand both close-up and long-range monitoring.

Smart Dual Light

With its smart dual light mechanism, the camera automatically turns on the white light when Perimeter Protection/SMD Plus function of AI XVR detects a target in the rule area to capture clear, vivid images. When the target leaves the rule area, the camera automatically switches over from the white light to the IR light to significantly reduce light pollution.

- * The parameters and datasheets below can only be applied to PT1200B series.
- * In order to use the Smart Dual Light HDCVI camera, the firmware of XVR must be upgraded to V4.001.0000004.1.R.220323 or later version.
- Max. 30 fps@1080p
- 3D NR
- Vari-Focal Dual-Lens
- 6× Hybrid Zoom
- Smart Dual Light
- 50m illumination distance
- Super Adapt
- Built-in MIC
- CVI/CVBS/AHD/TVI switchable
- IP66, 12 VDC

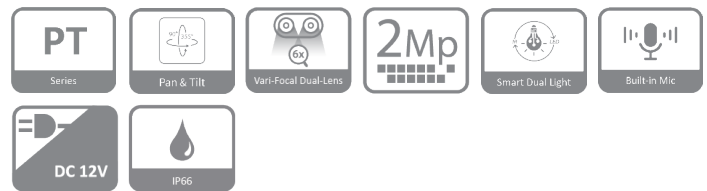

Built-in Mic

Audio signal transmission over coaxial cables is supported by the HDCVI camera. It adopts a unique audio processing and transmission technology that restores source audio and eliminates noise, ensuring the quality and reliability of the audio information that is collected. This becomes important for video surveillance applications that use audio information as a type of supplementary evidence.

Easy Installation

HDCVI PT camera comes with a quick-to-install design, which makes it easier to install than conventional camera and reduces cost on time and labor.

4 Signals over 1 Coaxial Cable

HDCVI technology supports 4 signals (video, audio*, data and power) which are simultaneously transmitted over a coaxial cable. Dual-way data transmission allows the HDCVI camera to interact with the XVR to perform various actions such as sending control signals and triggering alarms. HDCVI technology also supports PoC, which makes the camera easy and quick to install.

* Audio input is available for select HDCVI camera models.

Technical Specification					
Camera					
Image Sensor	2 MP CMOS				
Max. Resolution	1920 (H) × 1080 (V)				
Scanning System	Progressive				
Electronic Shutter Speed	PAL: 1/25 s–1/100,000 s NTSC: 1/30 s–1/100,000 s				
Min. Illumination	0.01 lux@F2.0 (Color, 30 IRE) 0.001 lux@F2.0 (B/W, 30 IRE) 0 lux (Illuminator on)				
S/N Ratio	>65 dB				
Illumination Distance	IR: 50 m (164.04 ft) Warm light: 50 m (164.04 ft)				
Illuminator On/Off Control	Auto/Manual				
Illuminator Number	4 (Multi-core light)				
Lens					
Lens Type	Fixed-focal				
Auto Focus	No				
Lens Mount	M12				
Focal Length	2.8 mm; 6 mm				
Max. Aperture	F2.0				
Field of View	2.8 mm: H: 109°; V: 59.6°; D: 130.4°; 6.0 mm: H: 47.2°; V: 26.2°; D: 54.5°				
Iris Control	Fixed				
Close Focus Distance	2.8 mm: 0.5 m (1.64 ft); 6 mm: 2.3 m (7.55 ft)				
DORI Distance	Lens	Detect	Observe	Recognize	Identify
	2.8 mm	41.4 m (135.83 ft)	16.5 m (54.13 ft)	8.3 m (27.23 ft)	4.1 m (13.45 ft)
	6.0 mm	95.1 m (312.01 ft)	38.0 m (124.67 ft)	19.0 m (62.34 ft)	9.5 m (31.17 ft)
	*DORI (Detect, Observe, Recognize, Identify) is a standard system (EN-62676-4) for defining the ability of a person viewing the video to distinguish persons or objects within a covered area. The numbers in this table do not reflect intelligent function distances. For intelligent function distances, refer to installation and commissioning manual/project design tool.				
Video					
Video Frame Rate	CVI: PAL: 1080p@25 fps; NTSC: 1080p@30 fps; AHD: PAL: 1080p@25 fps; NTSC: 1080p@30 fps; TVI: PAL: 1080p@25 fps; NTSC: 1080p@30 fps; CVBS: PAL: 960H; NTSC: 960H				
Resolution	1080p (1920 × 1080); 960H (960 × 576/960 × 480)				
Day/Night	Auto(ICR)/Color/B/W				
BLC	BLC; HLC; DWDR				
WDR	DWDR				
White Balance	Auto; Area white balance				
Gain Control	Auto/Manual				
Noise Reduction	3D NR				
Illumination Mode	Smart IR&WL; WL Mode; IR Mode				
Defog	Electronic defog				
Digital Zoom	6×				
Mirror	Yes				
Privacy Masking	Off/On (8 areas, rectangle)				
PT					
Pan/Tilt Range	Pan: 0°–355° Tilt: 0°–90° *Do not manually adjust the angle of the main body or enclosure.				
Preset	80				
Certification					
Certifications	CE-LVD: EN 62368-1; CE-EMC: EN 55032; EN 55035				
Audio					
Built-in Mic	Yes				
Camera Audio	CVI; TVI				
Port					
Video Output	Video output choices of CVI/TVI/AHD/CVBS by one BNC port				
Power					
Power Supply	12 VDC ± 30% (It is recommended to use a power adapter to supply the power for one camera)				
Power Consumption	Max 5.1 W (12 VDC, IR on)				
Environment					
Operating Temperature	–40 °C to +60 °C (–40 °F to +140 °F)				
Operating Humidity	<95% (RH), non-condensing				
Storage Temperature	–40 °C to +60 °C (–40 °F to +140 °F)				
Storage Humidity	<95% (RH), non-condensing				
Protection	IP66				
Anti-corrosion Level	Basic Protection				
Structure					
Casing Material	Plastic				
Product Dimensions	Φ110.0 mm × 150.0 mm (Φ4.33" × 5.91")				
Net Weight	0.46 kg (1.01 lb)				
Gross Weight	0.65 kg (1.43 lb)				
Installation	Wall mount; ceiling mount; vertical pole mount				

Ordering Information

Type	Model	Description
2MP Camera	DH-HAC-PT1200BP-IL-A-E2Z	2MP Smart Dual Light HDCVI Vari-focal PT Camera, PAL
	DH-HAC-PT1200BN-IL-A-E2Z	2MP Smart Dual Light HDCVI Vari-focal PT Camera, NTSC
Accessories (Optional)	DH-PFM800-E	1 Channel Passive HDCVI Balun
	DH-PFM321-EN	DC12V 1A power adapter
	DH-PFM321D-EN	DC12V 1A power adapter
	DH-PFM320D-EN	DC12V 2A power adapter
	PFM904	Integrated Mount Tester

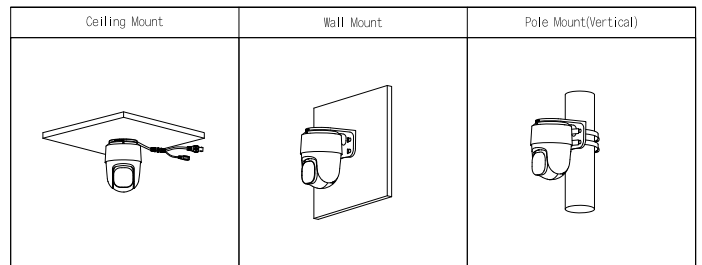

Dimensions (mm[inch])

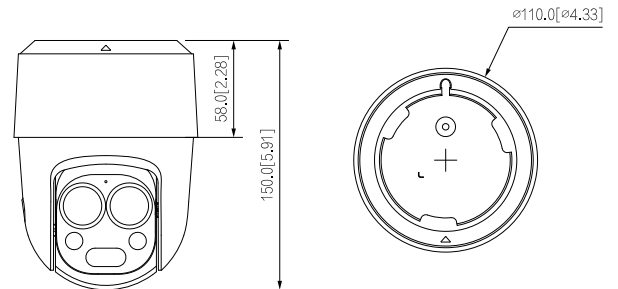

Accessories

Optional:



DH-PFM800-E
1 Channel Passive HDCVI
Balun



DH-PFM321-EN
DC12V 1A Power
Adapter



DH-PFM321D-EN
DC12V 1A Power
Adapter



DH-PFM320D-EN
DC12V 2A Power
Adapter



PFM904
Integrated Mount Tester